

CNC SWISS TURN LATHE XE 20H



Specification

Model		XE 20H
NC		Hanwha Fanuc-i
Max. machining diameter (mm)		Ø20
Main operation		
Z1 Stroke / NH (mm)		210
Main spindle	Speed (rpm)	10,000
	Motor (kW)	2.2 / 3.7
OD tool	No. of tools	6 □ (12mm) (Ø20)
Front tool	No. of tools	5 (ER16M, Ø25)
Cross drill	No. of tools	4 (ER16)
	Speed (rpm)	6,000
	Motor (kW)	1.0
Off-centre drill (opt)	No. of tools	2 (ER16)
Sub operation		
Sub spindle	Speed (rpm)	8,000
	Motor (kW)	1.5 / 2.2
Back tool	No. of tools	4 (ER16) (2 Fixed + 2 Driven)
	Speed (rpm)	6,000
	Motor (kW)	1.0
Machine size (L x W x H) (mm)		2,260 x 1,240 x 1,670
Weight (kg)		2,500
Power consumption (Cable size)		15 KVA, 10 KW (VCTF10SQ x 4C)
Air flow rate (Liter/Min)		120 ~ 150

* The specification is subject to change without notice.

Dimension

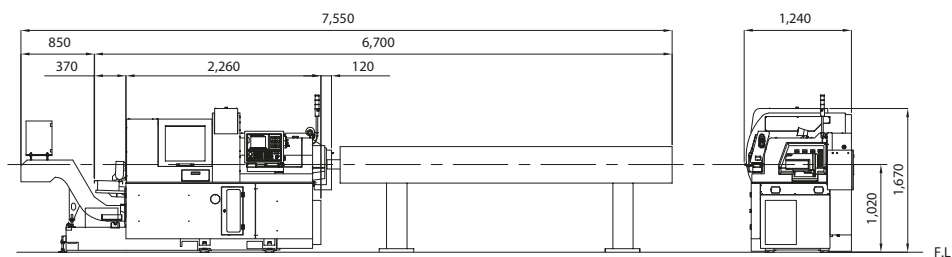



CNC SWISS TURN LATHE XE 20H

5 axis machine for high precision and efficiency

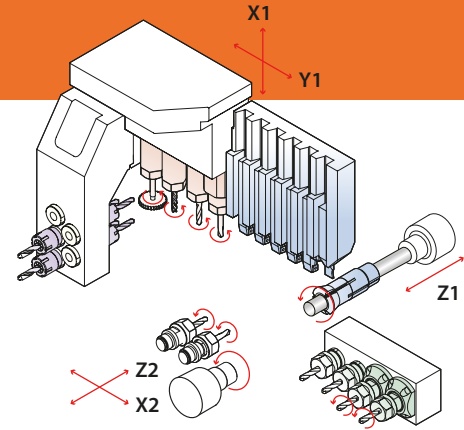

Precise Machining

- Precise and accurate guide bush
- Rigid structure for increased stability
- Generous tooling and maintenance area
- Cooling system for main and sub spindle

Machining Area



Main Spindle



Back Tool

