

Hanwha Precision Machinery / Machine Tool Division

www.hanwhaprecisionmachinery.com

9 Sungsanpaechong-ro, Sungsan-gu, Changwon, Kyungnam, South Korea(59 Sungsan-dong)

Tel. +82-55-280-4678 / +82-55-210-6419 Fax. +82-55-280-8930

Email. mtinfo@hanwha.com

Experience Your **SMART FACTORY**

Machine Tool Products



Hanwha Europe GmbH

Kölner Straße 10, 65760 Eschborn Germany

Hanwha Europe GmbH Technical Center

Hessenring 15B, 64546 Mörfelden-Walldorf, Germany

· Tel. +49-(0)-6105-7035-911

· Email. wsjung@hanwha.de

Hanwha TechM (Suzhou) Co., Ltd

North side of Sigang Segment, Zhangyang road, Zhangjiagang Economic and Technology development zone, Zhangjiagang, Jiangsu 215600, China

· Tel. +86-512-8017-9914~5

· Email. pjh1012@hanwha.com

Hanwha Machinery America Inc.

9750 South Oakwood Park Drive, Franklin, WI 53132, USA

www.hanwhamachinery.com

· Tel. +1-414-421-2300

EUROPE

Germany · Italy · Russia · Switzerland · Spain
Belgium · Netherland · Latvia · Ukraine
France · Portugal · Czech Republic · Poland
Hungary · Romania · Belarus · Bulgaria
Finland · Sweden · Turkey

ASIA

China · Hong Kong · India · Philippines
Israel · Thailand · Indonesia · Malaysia
Vietnam

AMERICA

U.S.A · Canada · Brazil · Argentina · Mexico
Venezuela · Costa Rica · Colombia

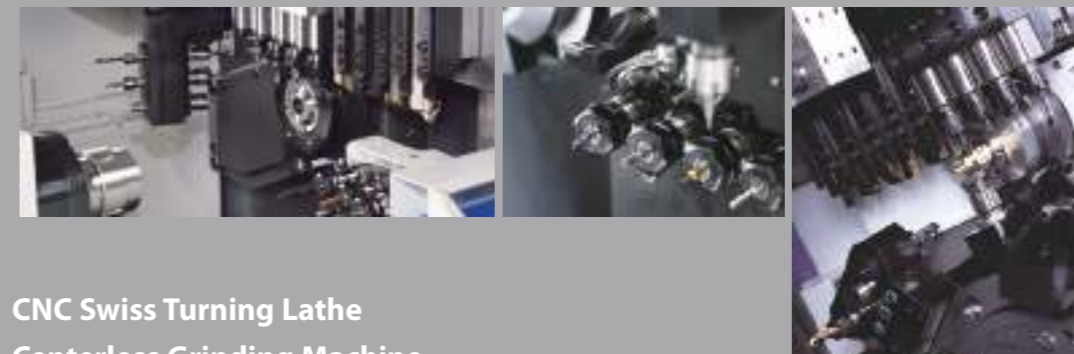

CNC Swiss Turning Lathe
Centerless Grinding Machine



Platforms

Hanwha CNC Swiss turning machines with a full line-up ranging from 3 to 42 mm, featured with high-grade CNC unit, complex tooling and high-rigidity machine structure can achieve high complex and precision machining. The Hanwha sliding headstock machines offer various range of models with optimized design combination as per customer's requirement.

CNC Swiss Turning Lathe

XP Series

Budget-friendly 4-axis entry models

- CNC unit : Hanwha Fanuc-i
- Ø12, 16, 20, 26, 32
- High-productivity machining for simple workpiece

08 **XP12/16S**

09 **XP20/26/32S**

XE Series

Value for money 5-axis models

- CNC unit : Hanwha Fanuc-i
- Ø20, 26, 35
- Affordability with stable and high productivity

10 **XE20/26**

11 **XE35**

XD Series

Flagship multi-axis models for high precision & complex machining

- CNC unit : Hanwha Fanuc-i, 32i-B
Siemens 828D, 840D
- Ø03, 07, 12, 16, 20, 26, 32, 38, 42

12 **XD03/07**

13 **XD12/16III**

14 **XD20/26II (F, S)**

16 **XD20/26II-V (F, S)**

STL Series

3-path controlled, powerful turret type models

- CNC unit : Siemens 840D
- Ø32, 38, 42
- Synchronous machining & 3 path control system
- Ultimate tooling capability with 10 station turret (VDI30 & BMT45)

24 **STL32/38 (S)**

26 **STL42 (S)**

34 Special Functions

Hi-CPS

Hanwha Smart Factory Solution

PCR / PCRS & Oscillation

Chip breaking solution

Customer & Performance Supporting Function

Centerless Grinding Machine

KCG Series

Single grip spindle for easy replacement

30 **KCG**

KCG-150CNC, KCG-200J,
KCG-200/300 (CNC)

HCG Series

High precision & rigidity centerless grinding machine with twin grip G/W and R/W spindle
※ HCG-150CNC : Single grip G/W spindle

31 **HCG**

HCG-150CNC, HCG-300 (CNC),
HCG-400 (CNC)



XE20/26

5-axis model with reliable performance for max. dia. 20/26mm

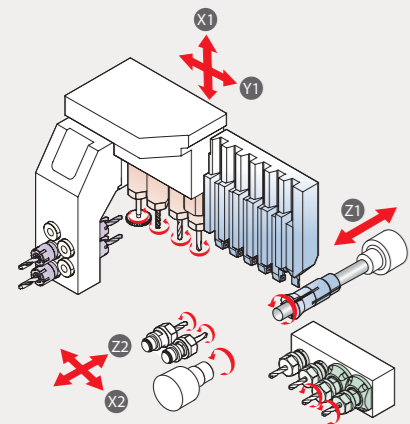

OPTION
 • Off-center drill (Driven, Fixed) 2
 • Cross 5 ~ 6



XE35

5-axis model with reliable performance for max. dia. 35mm

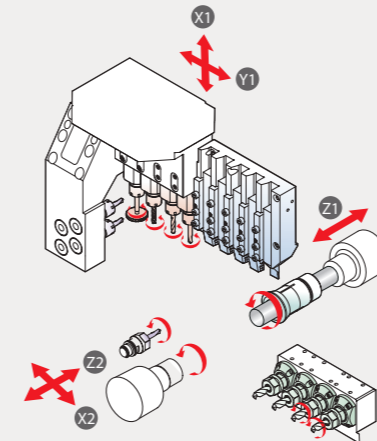

OPTION
 • Off-center drill (Driven) 1
 • Cross 5



OPTION TOOLING

Cross unit 5

- OD 5 (□16),
 Cross 5 (ER16M),
 Front 3 (ER16M)



Cross unit 6

- OD 6 (□16x1 + □11x5),
 Cross 6 (ER11Mx2, ER16x4)



※ Option : 3 Face/counterface driven tool,
 3 Face/counterface angle driven tool



Model	XE20/26				
	H	N	NH	J	Ne
NC	Hanwha Fanuc-i				
Max. machining diameter	Ø20/26				
Z1 Stroke (mm)	210	60	160 (H), 50 (N)	210	60
Main spindle	rpm	10,000 (Ø20), 8,000 (Ø26)			
	kW	2.2/3.7 (Ø20), 2.2/5.5 (Ø26)			
OD tool	No. of tools 6 (□12mm) (Ø20), 5 (□16mm) (Ø26)				
Front tool	No. of tools 5 (ER16M, Ø25)				
	No. of tools 4 (ER16)				
Cross drill	rpm 6,000				
	kW 1.0				
Off-center drill (Option)	No. of tools 2 (ER16)				
	rpm 8,000				
Sub spindle	kW 1.5/2.2				
	No. of tools 4 (ER16) (2 Fixed + 2 Driven)		4 (ER16) (4 Fixed)		
Back tool	rpm 6,000				
	kW 1.0				
Machine size (L x W x H) (mm)	2,260 x 1,240 x 1,670				
Weight (kg)	2,500				
Power Consumption (Cable size)	15kVA, 10kW (VCTF 10SQ x 4C)				
Air Flow rate (Liter/Min)	120 ~ 150				

* H : G/B & Driven back tool(2), J : G/B & Fixed back tool
 * N : Non-G/B & Driven back tool(2), Ne : Non-G/B & Fixed back tool, NH : Convertible G/B & Driven back tool(2)

Dimension

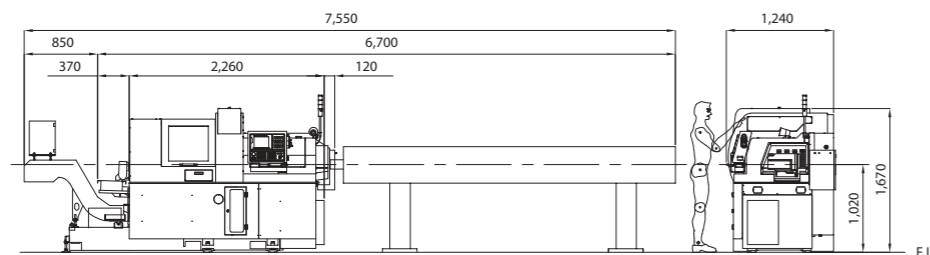

OPTION TOOLING

Cross unit 5

- OD 5 (□12),
 Cross 5 (ER16M),
 Front 5 (ER16M)



※ Cross(standard): Spline modular type
 ※ Option : 3 Face/counterface driven tool,
 3 Face/counterface angle driven tool



Model	XE35			
	H	N	J	Ne
NC	Hanwha Fanuc-i			
Max. machining diameter	Ø35			
Z1 Stroke (mm)	210	60	210	60
Main spindle	rpm	6,500		
	kW	2.2/5.5		
OD tool	No. of tools 5 (□16mm)			
Front tool	No. of tools 4 (ER16M, Ø25)			
	No. of tools 4 (ER16M)			
Cross drill	rpm 6,000			
	kW 1.0			
Off-center drill (Option)	No. of tools 1 (ER16)			
Sub spindle	rpm 6,500			
	kW 1.5/2.2			
Back tool	No. of tools 4 (ER16) (2 Fixed + 2 Driven)		4 (ER16) (4 Fixed)	
	rpm 6,000		-	
kW 1.0		-		
Machine size (L x W x H) (mm)	2,050 x 1,490 x 1,760			
Weight (kg)	2,750			
Power Consumption (Cable size)	15kVA, 10kW (VCTF 10SQ x 4C)			
Air Flow rate (Liter/Min)	120 ~ 150			

* H : G/B & Driven back tool(2), J : G/B & Fixed back tool
 * N : Non-G/B & Driven back tool(2), Ne : Non-G/B & Fixed back tool

Dimension

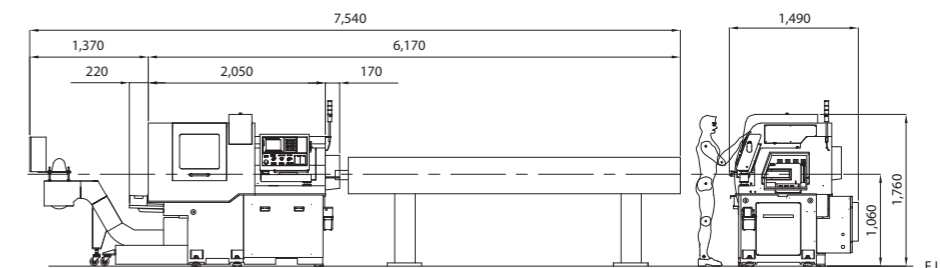

Options

Customized special option units are available for qualified performance, enhanced productivity and convenience

Standard & Option Accessory		XE series		XP series		XD series				XD series			STL series		
		XP12/16S	XP20/26/32S	XE20/26	XE35	XD03/07	XD12/16III	XD20/26II	XD20/26II-V		XD38II	XD38II-R	XD42	STL38	STL42
Off-cent unit	Driven(2)	-	-	★	★(1)	-	-	★	★		★	★	★(1)	-	-
	Fixed (long drill, 2)	-	-	★	-	-	★(1)	★	★		★(1)	★(1)	-	-	-
	Off-center Tailstock	-	-	★	★	-	-	★	★		★	★	★	-	-
Intenal coolant driven unit	Cross	-	-	★	★	-	★(Modular)	★	★		★	★	★	★	★
	Back	-	-	★	★	-	-	★	★		★	★	★	★	★
	Off-center	-	-	★	★	-	-	★	★		★	★	★	-	-
Fixed angle drilling unit	Cross, 1	-	-	▲	▲	-	-	▲	▲		★	★	★	★	★
	Back, 1	-	-	▲	▲	-	-	▲	▲		★	★	★	★	★
Option tool unit	Triple speed cross drill	-	-	★	★	-	★(Modular)	★	★		★	★	★	★	★
	Triple speed reduction cross drill	-	-	★	★	-	★(Modular)	★	★		★	★	★	★	★
	3 Face/counterface driven tool	-	-	★	★	-	-	★	★		★	★	★	-	-
	3 Face/counterface angle driven tool	-	-	★	★	-	-	★	★		★	★	★	-	-
	Gear hobbing	★	-	★	★	▲	▲	★	★		★	★	★	★(Turret)	★(Turret)
	Whirling	-	-	★	★	-	★	★	★		★	★	★	★	★
	Side cutter	-	-	★	★	-	★	★	★		★	★	★	★(Turret)	★(Turret)
	Modular(Y2)	-	-	-	-	-	-	-	★		★	★	★	-	-
Back tool cross	Single body(Y2)	-	-	-	-	-	-	-	★		★	★	-	-	★(Y3)
	Horizontal	-	-	★	★	-	-	★	★		★	★	★	-	-
Coolant unit	Chiller integrated High pressure coolant pump	▲	★	★	★	-	★	★	★		★	★	★	★	★
	Extended coolant tank	★	★	★	★	-	★	★	★		★	★	★	-	-
Chip conveyor	Standard chip conveyor	★	★	★	★	-	★	★	★		★	★	★	-	-
	Smart chip conveyor	-	-	★	-	-	-	★	★		★	★	★	-	-
	Lower type chip conveyor	★	★	★	★	-	★	★	★		★	★	★	★	★

★ : Option ▲ : Discussable - : N/A

Special Accessories

Swing Gripper

Gripper fingers to grip and release finished parts on to conveyor belt for ejection
- Applied example : vulnerable material, long parts

- XD20/26II, XD38II, XD42, XE20/26

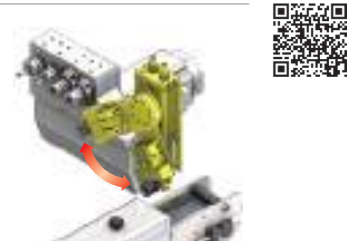

Parts Auto Loading unit

Auto loader for forged or diecasted parts to supply through main spindle door

- XD20/26II, XD38II, XD42, XE20/26



Auto stacking unit for machined parts

Auto loader for ejected parts onto a stacking pallet

- XD38II



Tooling Variation

XD20/26II

- Front/Back Tool
- Cross Drill
- Special Option Tool
- OD Tool

Cross 4

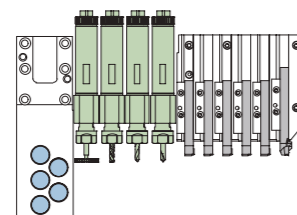

Cross 5

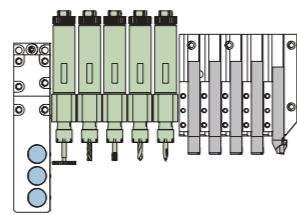

Cross 6

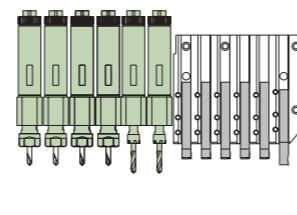

3 Face/counterface angle driven tool

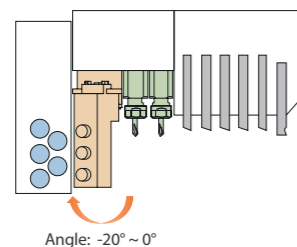

3 Face/counterface angle driven tool

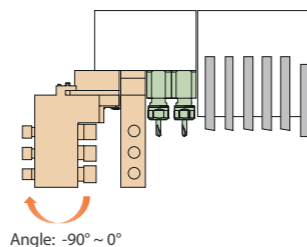

3 Face/counterface driven tool

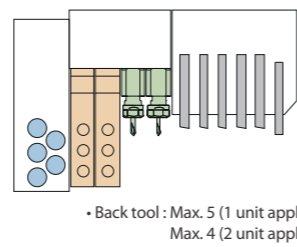

Whirling

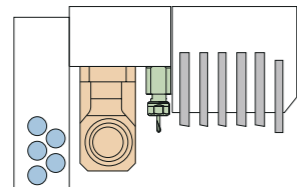

Gear Hobbing

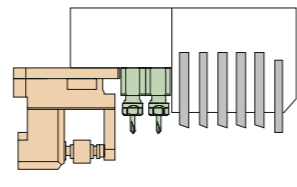

Polygon

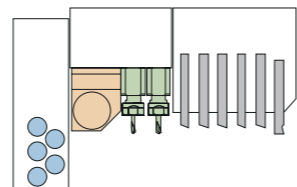

※ When special tool is installed, back tool unit should have max. 4 tools

XD38II

- Front/Back Tool
- Cross Drill
- Special Option Tool
- OD Tool

Cross 5

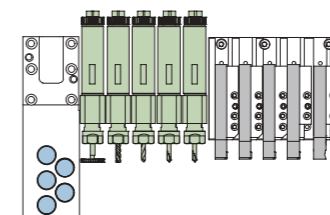

Cross 6

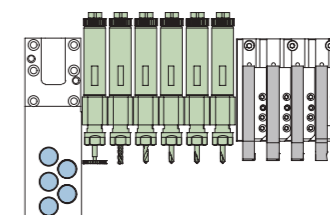

B-axis unit

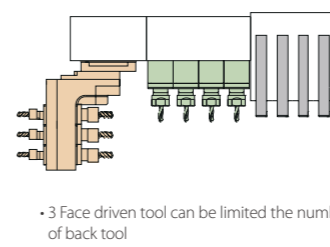

Fixed Angle Drilling

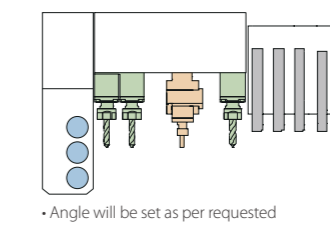

Back Tool Option Unit (Y2)

Fixed Angle Drilling

• Angle will be set as per requested

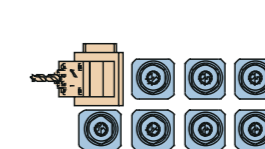

Back tool cross (Modular, Single body)

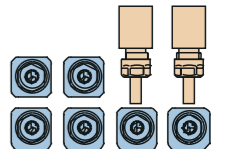

※ When special tool is installed, back tool unit should have max. 4 tools
※ Back tool option is available for both 6(Y2) and 8(Y2)

Hi-CPS

Hanwha Intelligence CNC Prognostic System



Hi-CPS is a kind of smart factory solution to enable customers to manage factory in a smart & convenient way by providing real time monitoring on running status of machines at the facility. It is a cloud-based system so that one can access with ease from anywhere through internet.

Function

- 1 Monitoring**
 - Monitors machine operation status from PC & Mobile
 - Check machining, repair, alarm, cycle time, etc.
- 2 Diagnosis**
 - Remotely examines alarmed machines at user's online request
 - ※ Only at customer's request, relevant machine data will be auto-transferred to Hanwha for analysis
- 3 Prognosis**
 - Analyzes cutting load, tool change and offset

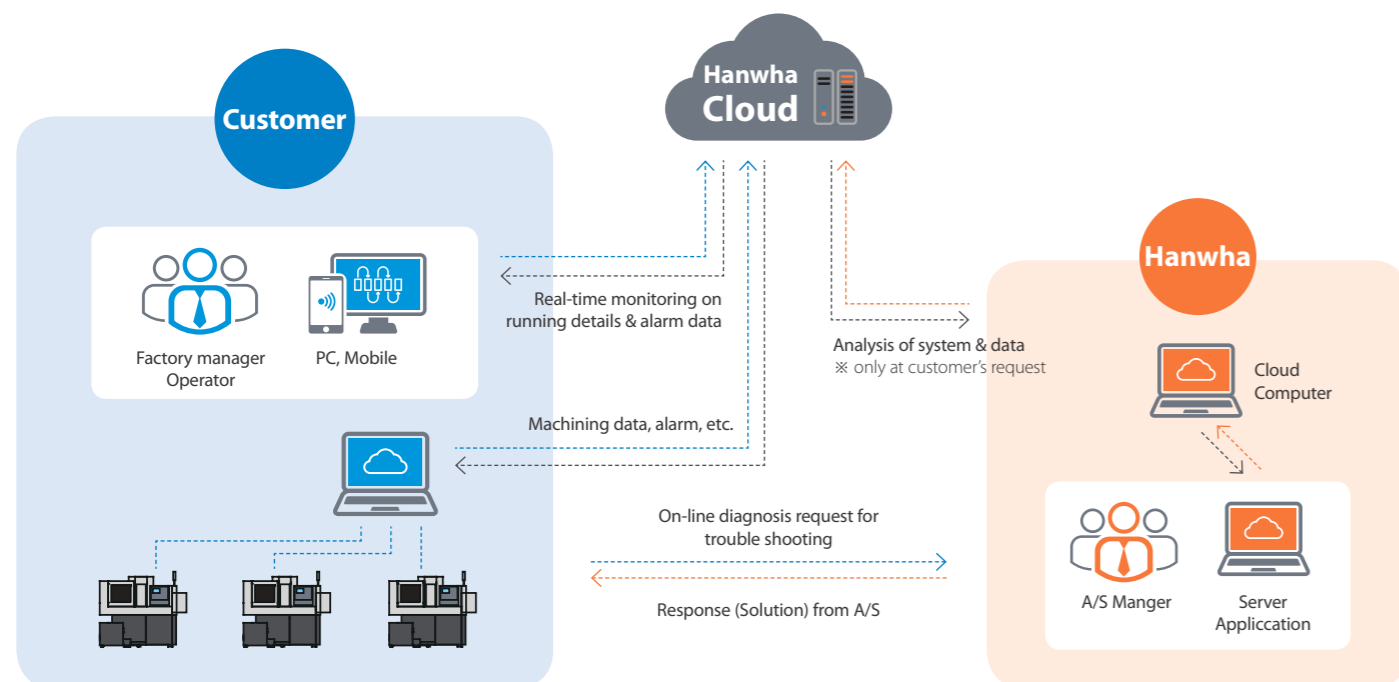

PCR / PCRS & Oscillation

Chip breaking solution



Hanwha provides chip cutting solution to break long and curled chips into small pieces through macro program.

Advantage

- Better tool life
- Build-up edge free
- Chip trouble free
- Coolant usage saved



Model	PCR	PCRS	Oscillation
NC	FANUC 32i-B	SIEMENS 828D/840D	Fanuc 0i-TD / 0i-TF / 32i-B
Front turning	•	•	•
Back turning	•	•	•
Back drilling	Fixed drills	•	Fixed drills
Taper	•	•	45° angle
Circular interpolation	•	•	•
Synchronous control	•	•	x
Threading	•	•	x
Nose R compensation	x	•	x

Customer & Performance Supporting Function

Hanwha offers various software for enhancing machining performance & supporting customer's convenience.

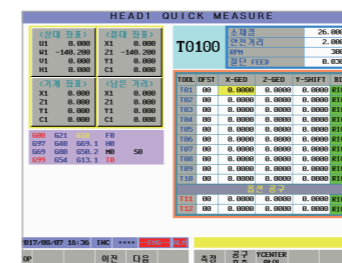

Quick Measuring
Setting time reduce system
 Supports tools setting with minimal control and none of screen change

Collision Protection
 Easy setting of value to protect collision before occurring

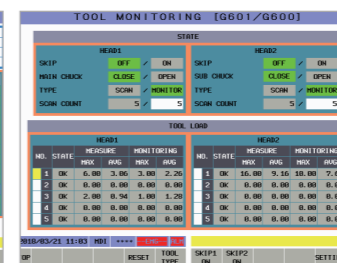

Tool Load Monitoring
 Alarms when abnormal load on tools are detected

M7
 Single code to command cut-off of material



3D Chamfer Solution
 Uniform chamfer machining on cross hole with input of single code

G301
 Single code to set the position of Z2-axis for cut-off of material

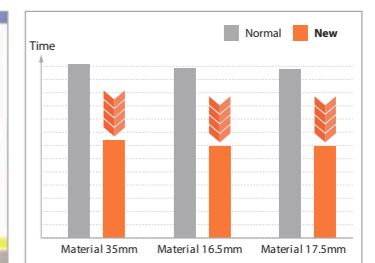

Motion Optimization
C/T reduce system
 Reduces cycle time by minimizing unnecessary motion (non processing time)

Help function
 Provides description & graphic information about codes & alarms with